

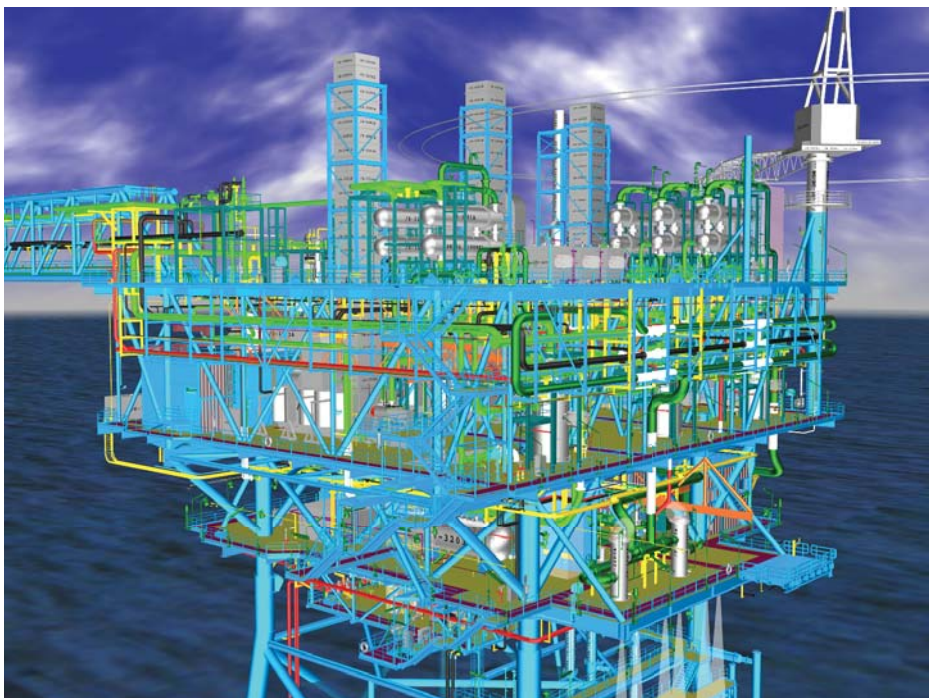

THAI NIPPON STEEL & SUMIKIN ENGINEERING & CONSTRUCTION CORP., LTD.



**CONTINUOUS IMPROVEMENT
IS OUR CULTURE**



TNS INFORMATION



► Company Information ◀

THAI NIPPON STEEL & SUMIKIN ENGINEERING & CONSTRUCTION CORP., LTD. (TNS) was established in 1987 by Nippon Steel Corporation (a worldwide leader in steel manufacturing and engineering), Nippon Steel Trading, and Ialthai Group (a Thai industrial conglomerate).

The core businesses of TNS are Front End Engineering Design (FEED) / Basic Engineering, Detailed Engineering, Fabrication Engineering, Procurement, Fabrication / Construction, Installation, Pre-commissioning and Commissioning of Upstream and Downstream works including offshore facilities, onshore modules and so on.

TNS also provides offshore platform facilities maintenance & modification work services, offshore scaffolding services, offshore painting services and welding engineering services.

► Core Business ◀

Engineering & Procurement Services

- FEED, Detailed Engineering and Fabrication Engineering
- Procurement Services

Construction

- Offshore Upstream Oil & Gas Facilities
- Onshore Structures
- Pressure vessel & Tanks
- Onshore Modules and LNG Plant

Offshore Installation

Offshore Services

- Offshore Brown-field Works / Offshore Services
- Hook-up and commissioning
- Maintenance and modification services



1st Ever Build Monopod In Thailand



TNS Management walkabout to identify risk in construction yard

► Engineering ◀

TNS Engineering office locates at Ample Tower, Bangna-Trad Rd. We support all detailed engineering and fabrication engineering under one roof. The core strength of TNS engineering is a resource pool of personnel having extensive experience in the field of upstream oil and gas sector EPC projects.

TNS offers Conceptual Engineering, Front End Engineering Design and Detail Engineering for wellhead platform, central processing platform, compression module, water injection module, living quarter module and fabrication engineering for generation of fabrication drawing for structural, piping, mechanical, electrical and instrumentation disciplines.

Established engineering disciplines include process, mechanical, piping, instrumentation, electrical, structural, facility design (piping & mechanical), facility design (E&I), and structural design.

It has well equipped engineering office buildings accomodating all the above disciplines with the required modern infrastructure and IT systems / resources. Engineering activities are carried out using the latest available / industry proven software resources including PDMS, TEKLA, ETAP, HYSIS, CAESAR-II.

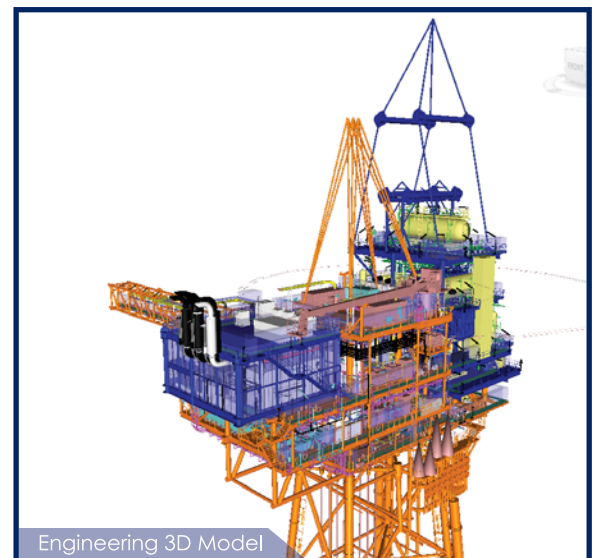
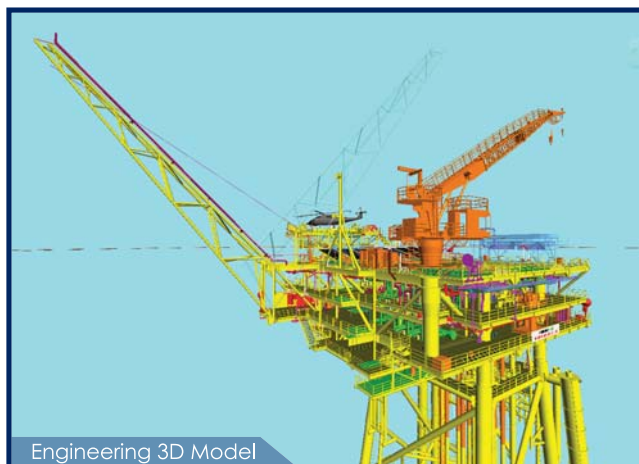
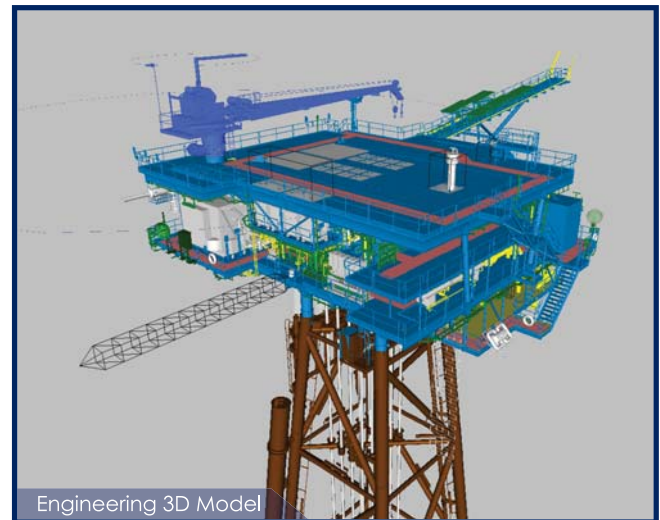

► Construction ◀

Capability

TNS has two large and well equipped fabrication yards at Amara and Bangpakong, both located close to Bangkok.

Amara yard

Location: 30km south of Bangkok at the mouth of the Chao Phraya River
Total Area: 130,000 square meters

Production Capacity:

Structural (Tons / Year) : 20,000

Piping (Spools / Year) : 12,000 (approx 120,000 DB)

4 Covered fabrication shops for structural, piping and E&I

3 Covered blast & paint shops

Covered storage warehouses

Amara yard can accommodate up to six wellhead platforms (deck & jacket) at one time.

Bangpakong yard

Location: 47km south east of Bangkok at Bangpakong River side
Total Area: 373,000 square meters
(Potential for expansion to 400,000 square meters)

Production Capacity:

Structural (Tons / Year) : 40,000

Piping (Spools / Year) : 25,000 (approx 250,000 DB)

4 Covered fabrication shops for structural, piping and E&I

Covered blast & paint shop

Covered storage warehouses

Bangpakong yard can accommodate several wellhead platforms (deck & jacket) at one time or other type of oil & gas platform including Central Processing Platforms, Compression Module or Platform, Living Quarter Platform, Onshore Modules and LNG Plants

Our fabrication shop is accredited with ASME "U" and "R" stamp.



Platform complete construction from our facility



module complete construction from our facility



Facilities

Other facilities at Amara & Bangpakong yards

Dedicated facilities for client offices, first aid rooms, welding schools, open storage areas, open fabrication and assembly areas, painting material storage areas, blasting & painting areas, gas storage, hazardous waste areas, storage for fabricated components, canteens, toilets / worker rooms, car parks, all available at both yards.

Facilities	Amara yard	Bangpakong yard
Wharf Facilities	3 numbers	4 numbers
Quayside Draft	6 meters (MSL)	6 & 10 meters (MSL)
Skid-way	2 Skid-ways	2 Skid-ways
Load-out capacity	2x2,500 MT for Jacket 5,000 MT for Deck	2x2,500 MT for Jacket (jetty No. 2&3) 7,500 MT for Deck (jetty No.1) 20,000 MT (jetty No.4)
Load-out method	SPMT (Self-Propelled Modular Transporter) & Skidding Method (By winches or Strand-Jack) Lifting by crawler crane	

Major equipment at Amara & Bangpakong yards

Heavy Cranes

- Crawler crane 650 tons
- Crawler crane 300 tons
- Crawler crane 150 tons
- Crawler crane 90 tons
- Gantry crane 20 tons
- Heavy lift crane can be outsourced for high workload

Fork Lifts and Trucks

- Forklifts 3-5 tons
- Truck (6 wheel) 10 tons

- Type of Welding Machine: FCAW, SAW, SMAW, GMAW, GTAW
- HGG for TKY cutting machine & CNC Plate cutting machine
- NDE: MT, UT carried in-house by TNS personnel / equipment
- Instrument Calibration Equipment, Electrical Test Facilities
- Hydro Testing Equipment
- Scaffolding
- Load-out Equipment : Winches, Pumps, Slings and Shackles SPMT by subcontractor
- Weighing Equipment : 200T Hydraulic Jack & loadcell

Fabrication Set-up

Each yard has respective structure, piping, mechanical, electrical, instrument, protective coating, quality control, logistics & material control yard facility, maintenance, planning to meet clients' needs.



Construction activity

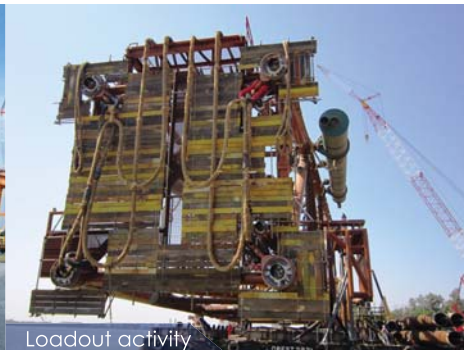

Loadout activity



Installation activity



HUC & INSTALLATION

► Offshore Installation ◀

NIPPON STEEL & SUMIKIN ENGINEERING (NSENGI) our group company in Singapore provides a full range of installation services including:

- Marine Transportation
- Platform Installation
- Pipeline Installation
- Decommissioning of offshore structures

► Offshore Services ◀

TNS has a fully-fledged Brownfield Division, which provide full range of offshore activities as follows:

- Construction Work Pack Development
- Green Field Hook-up & Tie-ins works
- Brown Field Works namely
 - Pre-works and modification
 - Retro-fit
 - Rejuvenation works
 - Total revamp
 - Well tie-in works
 - De-bottlenecking
 - Upgrading works
 - Conversion scheme
 - Pre and Post drilling works
 - Pre-commissioning and Commissioning
- Start-up assistance



Installation activity by NSENGI Kuroshio



Installation activity



Offshore team activity



Offshore team activity



Offshore team activity

QA / QC

► Quality Assurance / Quality Control ◀

TNS is committed to implementing and maintaining an effective quality management system which ensures customer quality requirements, including statutory / regulatory requirements.

TNS Quality Management System is applicable to engineering design, procurement, construction, installation, pre-commissioning and commissioning of onshore and offshore oil and gas platform and process facilities and onshore structure. TNS Quality Management System is developed in accordance with ISO 9001:2008.

TNS provides a high level of quality and services that meets and surpasses our customer requirements. TNS performs work with a professional approach to meet quality control procedures. TNS also conducts regular reviews for continual improvement in human resources, facilities, and work environment with a view to enhancing our services and our quality objectives.



Quality Control Activities



- TNS have ample resources of manpower with credentials of international level that possess inspection certificates, such as, CSWIP, PCN, BGAS, ASNT and NACE.
- Inspections are being carried out independent from production and in compliance with the agreed Inspection and Test Plan as agreed with our Customers or Client.



TNS Wi-Fi Barcode System



TNS is committed to achieving the highest Health, Safety, and Environment (HSE) Standards across all operations and consistently meets or exceeds the needs and expectations of our clients.

A fully functional Health, Safety, and Environmental Management System (HSEMS) is effective to provide high level of performance related to HSE risks across all operations.

Health, Safety and Environmental Management System covers the following major aspects:

- Safety Inspection and Audit Procedure
- Material Safety Data Sheet (MSDS)
- Confined Space Entry Procedure.
- Work permit system
- Potential Risk Alert Procedure
- Safety Emergency Response Training Procedure
- Hygiene condition checking program
- Fire prevention procedure
- Incident & Accident Report Investigation
- Scaffolding Safety Procedure
- Lifting / Rigging and Transportation Safety Procedure
- Safety and Discipline for Offshore works
- Environment Protection Procedure
- Safety Induction
- Electric Safety Procedure

TNS Health, Safety, and Environment Management System (HSEMS) has been established and implemented in accordance to the requirement of OHSAS 18001:2007 and ISO 14001:2004



Tool Box Talk



ISO 14001:2004 / TIS18001:1999 / OHSAS 18001:2007 Certificates



In-house Fire drill training



► Corporate Social Responsibility (CSR) ◄

THAI NIPPON STEEL & SUMIKIN ENGINEERING & CONSTRUCTION CORP., LTD. (TNS), in its ongoing support for and commitment to social awareness, consider CSR a primary policy. TNS is therefore dedicated to benefiting Thai society and to being fully committed to the Kingdom of Thailand and its people. To illustrate its devotion, TNS pledges to contribute to a better society and to protect the environment.

Having certified by Ministry of Industry for Good Environmental Government, TNS is proudly to be environmental cared company.



TNS award Green Industry



Contribution fund to support flood victim

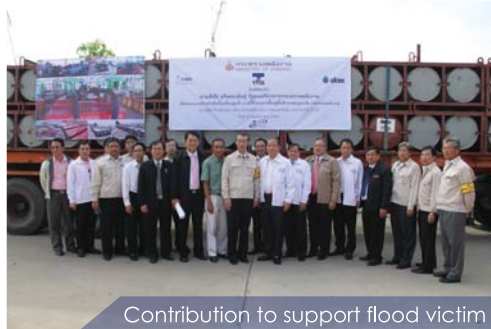

Contribution to support flood victim



TNS support artificial reef project



Contribution to local school



Support Children Day activity



Support reforestation project



Donated used computers



Empower our employees



Sharing to improve local community



"Continuous Improvement is our Culture"



THAI NIPPON STEEL & SUMIKIN ENGINEERING & CONSTRUCTION CORP., LTD.

Amara Yard

390 Moo 6, Tai-Ban Road,
T. Tai-Ban, A. Muang,
Samutprakarn, Thailand 10280

Tel: (+66) 02 703 5160 (Auto 10 lines)
Fax: (+66) 02 703 5164

E-mail: enquiries@thainippon.co.th

Bangpakong Yard

14 Moo 14, Sukhumvit Road (Old Road),
T. Bangpakong, A. Bangpakong,
Chachoengsao, Thailand 24130

Tel: (+66) 038 832 369, 02 755 2800
Fax: (+66) 038 832 408

Website: <http://www.thainippon.co.th>

Bangna Office

18th - 19th Floor, Ample Tower
120 Moo 11, Bangna-Trat, Bangna
Bangkok, Thailand 10260

Tel: (+66) 02 744 3049
Fax: (+66) 02 744 3108



(Download E-Brochure)